

2 Push the paddle under the seat in

3 Roll front wheels forward

4 PUSH DOWN seat to lock the frame (You will hear "Click" sound)

! Please make sure nip-glide is fully open before use

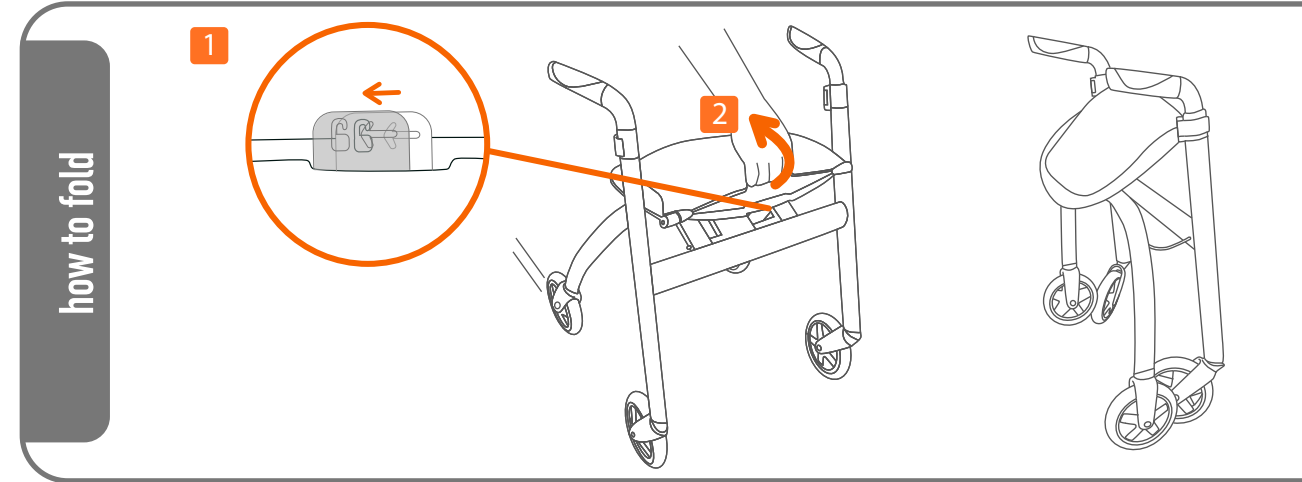

1 2 Release auto lock by pushing the latch to left and hold then lift up the seat

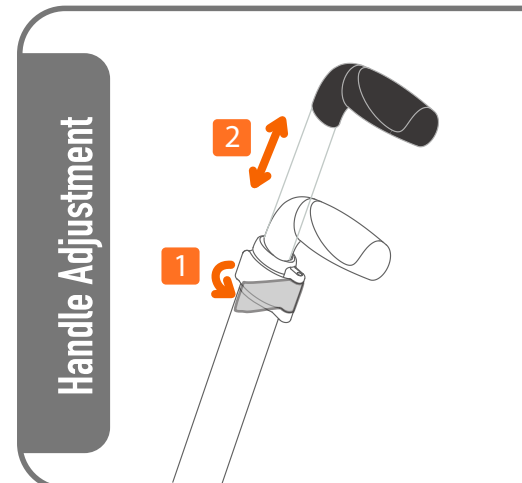

1 Open the clip

2 Adjust the height of handle

3 and Close the clip

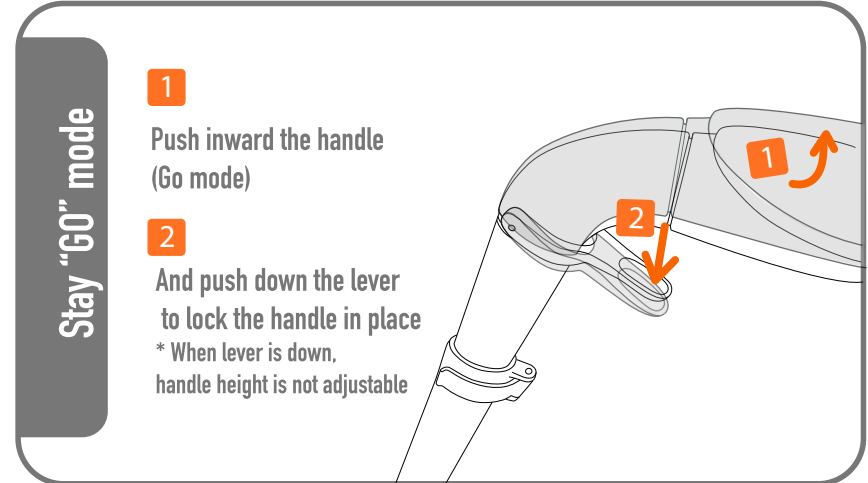
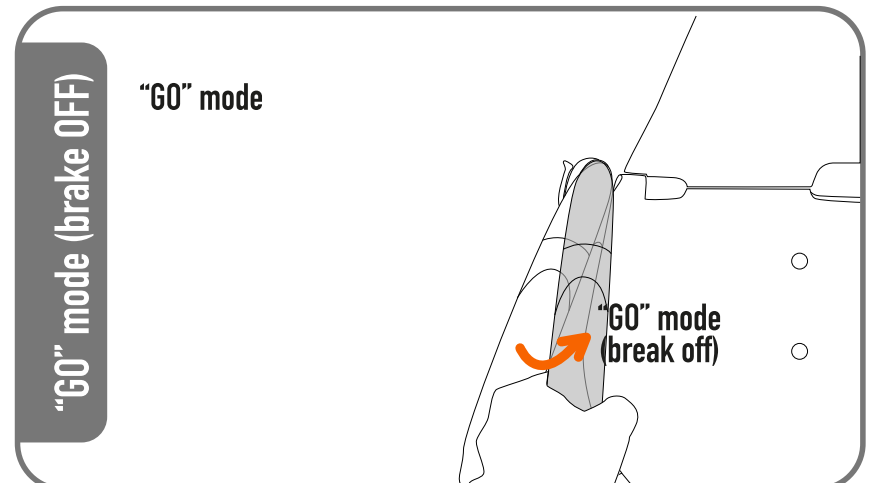

Stay "GO" mode

1 Push inward the handle (Go mode)

2 And push down the lever to lock the handle in place
* When lever is down, handle height is not adjustable

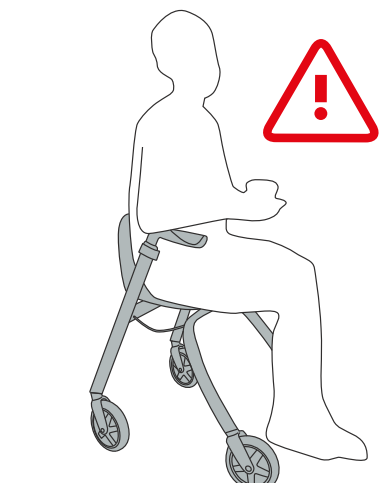

! MUST ACTIVATE BRAKE (NO "GO" MODE) for SEAT mode

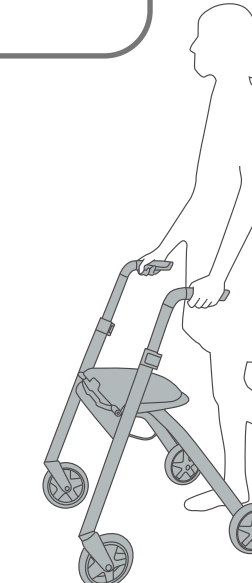

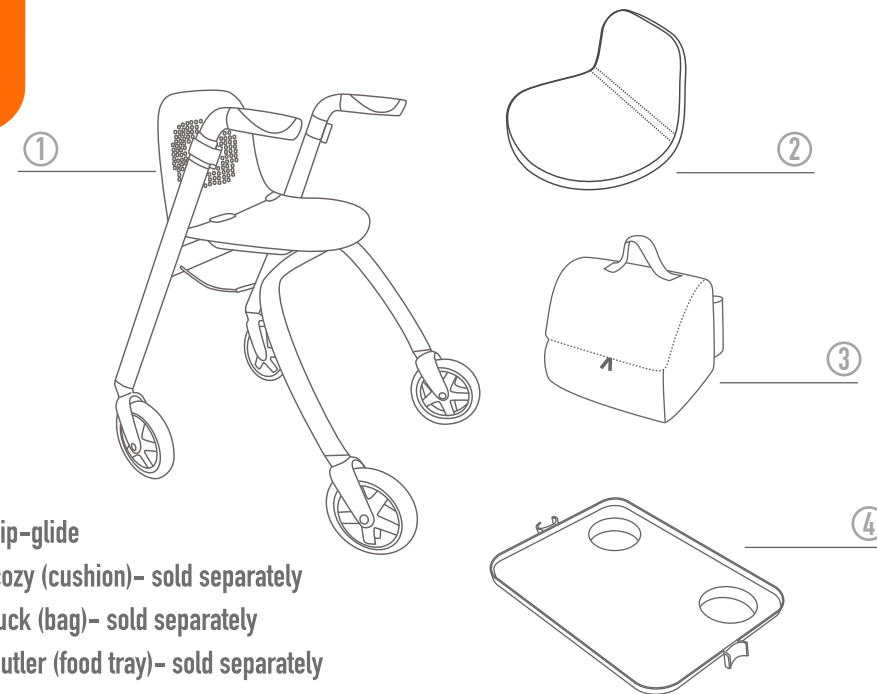

- ① your nip-glide
- ② your cozy (cushion)- sold separately
- ③ your tuck (bag)- sold separately
- ④ your butler (food tray)- sold separately



NIP can take Maximum Weight 120kg/265lbs
 NIP handle height can be adjustable 74-93cm/30-37"
 Recommended height of user is 150~185cm/4.9~6ft
 NIP Max turning distance is 85cm/33.5" diameter

⚠ WARNINGS

Please don't use nip-glide for any other purpose such as wheelchair/stroller than as a walking aid.

Do not hang anything from nip-glide handles or frame.

Do not use the seat without the back rest in place.

Recommend to consult with your doctor, physiotherapist or OT regarding you are suitable to operate nip-glide correctly.

MAX load for TUCK(BAG) is 5kg. If it exceeds max weight, it could put you at risk when using nip-glide.

♥ MAINTENANCE

Regularly verify that screws(seat area) are properly tightened.

Make sure your brake works well. If there is any sign of brake wear, please contact the service centre. Contact us by emailing help@bc2-limited.com

Keep wheels clean and replace wheels if worn or damaged

Care Instruction for tuck(bag) and cozy(cushion)

Brush off dirt / Hand wash in warm water only / Rinse well / Do not tumble dry / Do not Iron / Do not bleach / Do not dry clean / Dry in shade away from direct sunlight / Do not use detergents

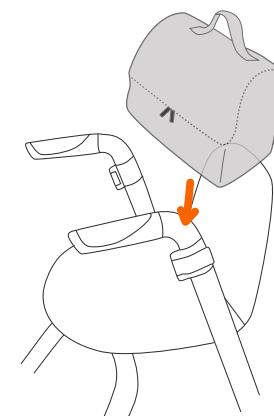

Recommended TUCK(BAG) position

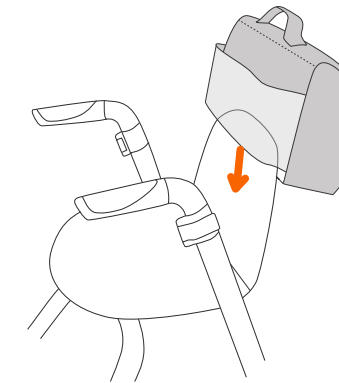

TUCK can be placed outward of seat when user is seated
MUST NOT EXCEED MAX WEIGHT(5kg)

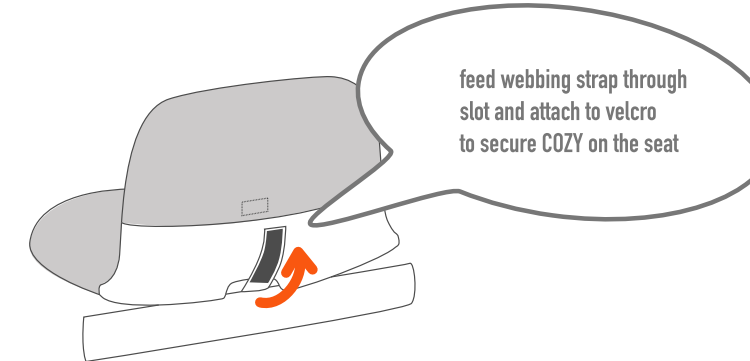

nip-glide™ INSTRUCTION

Please read this instruction before use for your safety